

- Notes:**
- 1.) Total platted area contains 0.252 acres of land.
 - 2.) Bearings are based on the recorded plat of Safe Harbor Addition Unit 2, a map of which is recorded in Volume 64, Pages 115-116, Map Records of Nueces County, Texas.
 - 3.) By graphic plotting only, this property is in Zones "AE (EL 8)" and "AE (EL 9)" on Flood Insurance Rate Map, Community Panel No. 485498 0006 F, City of Port Aransas, Texas, which bears an effective date of September 30, 1992 and is in a Special Flood Hazard Area.

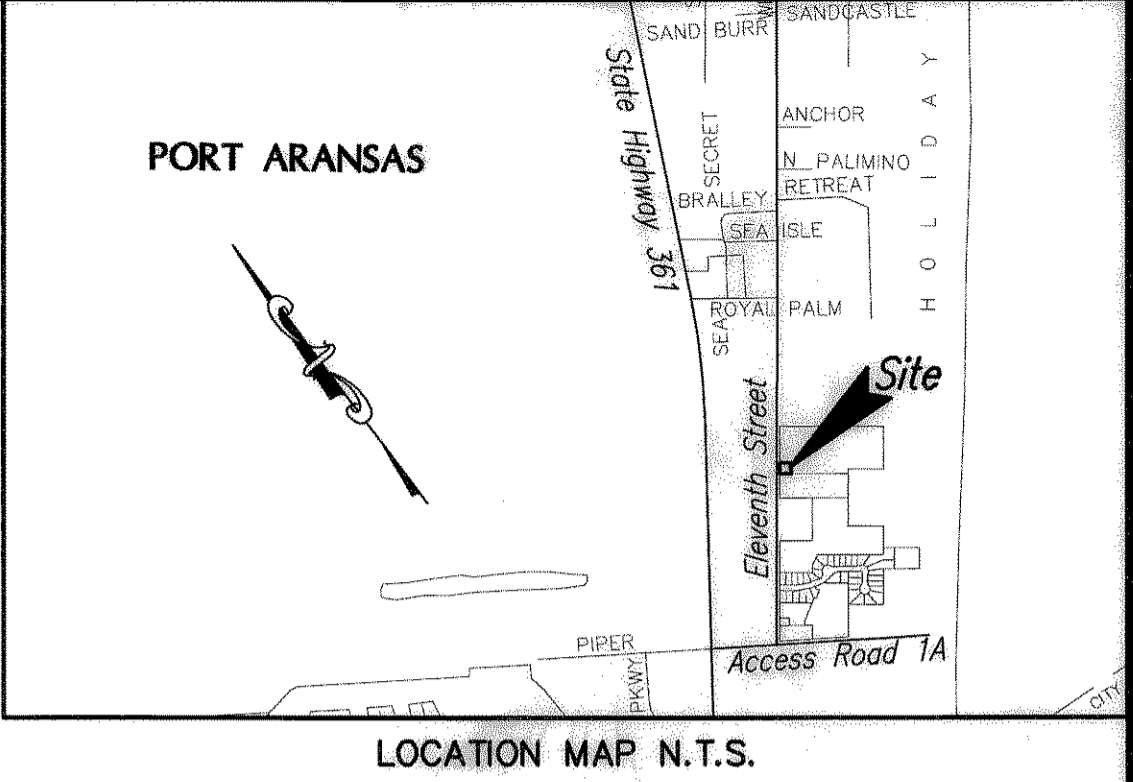

State of Texas
County of Nueces

I, Dan L. Urban, a Registered Professional Land Surveyor for Urban Engineering, have prepared the foregoing map from a survey made on the ground under my direction and is true and correct to the best of my knowledge, information and belief; I have been engaged under contract to set all Lot and Block corners as shown hereon and to complete such operations with due and reasonable diligence consistent with sound professional practice.

This the 15th day of June, 2006

Dan L. Urban
Dan L. Urban, R.P.L.S.
Texas License No. 4710

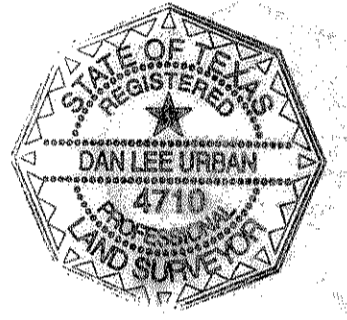

State of Texas
County of Nueces

This final plat of the herein described property was approved by the City Engineer for the City of Port Aransas, Texas.

This the 14th day of JUNE, 2006

Craig B. Thompson
City Engineer

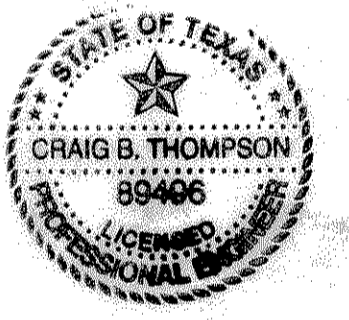

State of Texas
County of Nueces

This final plat of the herein described property was approved on behalf of the City of Port Aransas, Texas by the Building Official.

This the 12th day of June, 2006

Joe J. Lamb
City Building Official

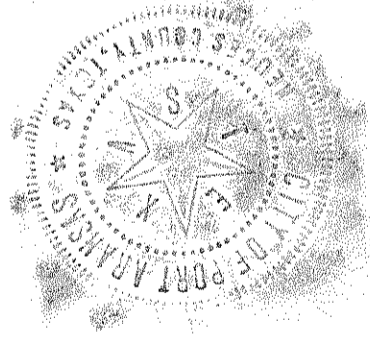

State of Texas
County of Nueces

I, Diana T. Barrera, Clerk of the County Court in and for said County, do hereby certify that the foregoing instrument dated the 14th day of June, 2006, with its certificate of authentication was filed for record in my office the 14th day of June, 2006, at 1:28 O'clock P.M., and duly recorded the 14th day of June, 2006, at 1:28 O'clock P.M., in said County in Volume 65, Page 131, Map Records.

Witness my hand and seal of the County Court, in and for said County, at office in Corpus Christi, Texas, the day and year last written.

No. 2006030681
Filed for Record
at 1:28 O'clock P.M.
June 14, 2006

Diana T. Barrera
Diana T. Barrera, County Clerk
Nueces County, Texas
By: *Pamela B. Aniega*
Deputy

Diana T. Barrera
Clerk County Court
Nueces County, Texas

By: *Pamela B. Aniega*
Deputy

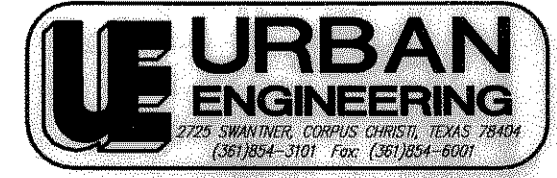

DATE: May 3, 2006
SCALE: 1"=20'
JOB NO.: 40556.00.00
SHEET: 1 of 1
DRAWN BY: XG

State of Texas
County of Nueces

We, CHRISTENSEN CONSTRUCTION, L.L.C., hereby certify that we are the owner of the lands embraced within the boundaries of the foregoing plat; that we have had said lands surveyed and subdivided as shown; that easements as shown are dedicated to the public use for the installation, operation and use of public utilities; and that this map was made for the purpose of description and dedication.

This the 16th day of June, 2006

By: CHRISTENSEN CONSTRUCTION, L.L.C.

Jon Christensen
By: JON CHRISTENSEN, Managing Partner

State of Texas
County of Nueces

This instrument was acknowledged before me by JON CHRISTENSEN, as Managing Partner of CHRISTENSEN CONSTRUCTION, L.L.C.

This the 16th day of June, 2006

Xavier Galvan
Notary Public in and for the State of Texas

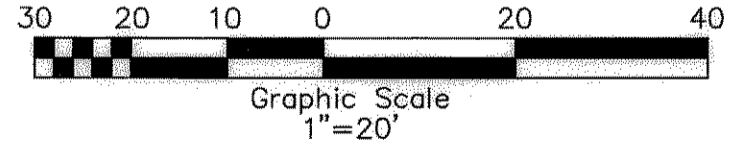
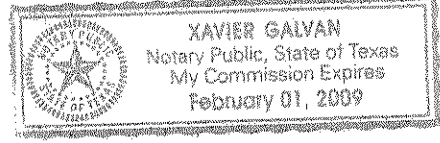

Plat of
Safe Harbor Addition Unit 2
Block 3, Lot 12A

being a replat of Lot 12 Block 3, Safe Harbor Addition Unit 2, a map of which is recorded in Volume 64, Pages 115-116, Map Records of Nueces County, Texas.