

# PLAT OF BARCLAY GROVE UNIT 1

BEING 16.574 ACRES OF LAND OUT OF LOTS 1,2,3, SECTION 10 AND LOTS 30, 31 AND 32, SECTION 11, FLOUR BLUFF AND ENCINAL FARM AND GARDEN TRACTS, A MAP OF WHICH IS RECORDED IN VOLUME A, PAGES 41-43, MAP RECORDS OF NUECES COUNTY, TEXAS.

**NOTES:**

1. TOTAL AREA = 16.574 ACRES OF LAND
2. 5/8 INCH IRON RODS SET AT ALL LOT CORNERS.
3. THE YARD REQUIREMENT (Y.R.), AS DEPICTED ON THIS PLAT, IS A REQUIREMENT OF THE ZONING ORDINANCE AND IS SUBJECT TO CHANGE AS THE ZONING MAY CHANGE.
4. NO RESIDENTIAL DRIVEWAY ACCESS IS PERMITTED TO LIPES BOULEVARD

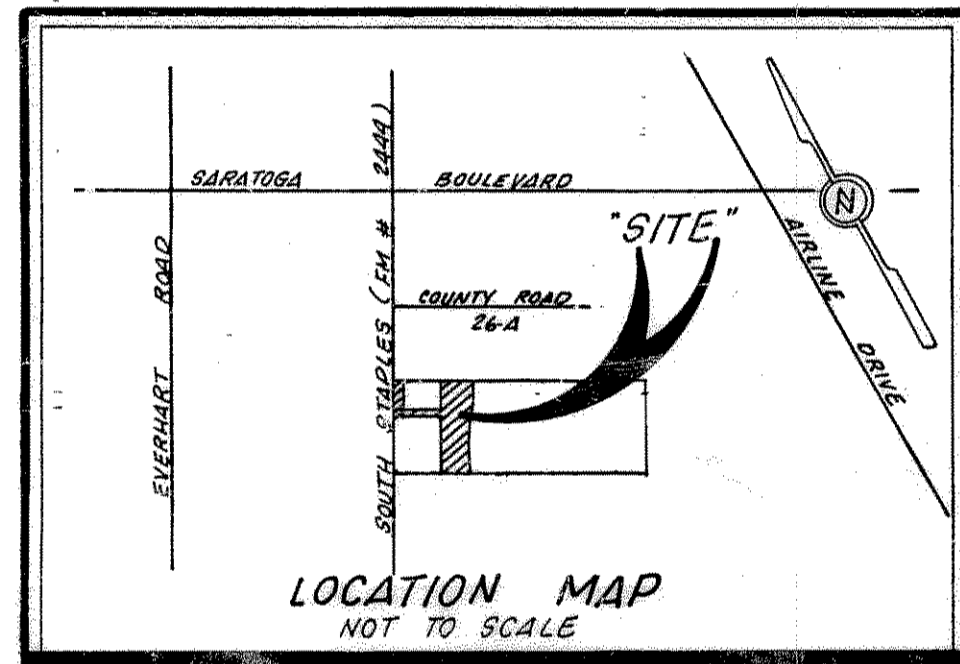

STATE OF TEXAS  
COUNTY OF NUECES

SHELL DEVELOPMENT JOINT VENTURE, A JOINT VENTURE, HEREBY CERTIFIES THAT IT IS THE OWNER OF THE LANDS EMBRACED WITHIN THE BOUNDARIES OF THE FOREGOING PLAT; THAT IT HAS HAD SAID LAND SURVEYED AND SUBDIVIDED AS SHOWN; THAT STREETS AS SHOWN ARE DEDICATED TO THE PUBLIC USE FOREVER; THAT EASEMENTS AS SHOWN ARE DEDICATED TO THE PUBLIC USE FOR THE INSTALLATION, OPERATION, AND USE OF PUBLIC UTILITIES; AND THAT THIS MAP WAS MADE FOR THE PURPOSE OF DESCRIPTION AND DEDICATION.

THIS THE 14 DAY OF APRIL, 1994.

SHELL DEVELOPMENT JOINT VENTURE

*Benjamin B. Wallace*  
BENJAMIN B. WALLACE, PRESIDENT OF SHELL LAND MANAGEMENT COMPANY, INC., A TEXAS CORPORATION

STATE OF TEXAS  
COUNTY OF NUECES

THIS INSTRUMENT WAS ACKNOWLEDGED BEFORE ME BY BENJAMIN B. WALLACE, AS PRESIDENT OF SHELL LAND MANAGEMENT COMPANY, INC., A TEXAS CORPORATION ON BEHALF OF SAID CORPORATION, AND THE CORPORATION ACKNOWLEDGED THIS INSTRUMENT AS MANAGING JOINT VENTURER ON BEHALF OF SHELL DEVELOPMENT JOINT VENTURE, A JOINT VENTURE.

THIS THE 14 DAY OF APRIL, 1994.

*Moises Perez, Jr.*  
NOTARY PUBLIC IN AND FOR THE STATE OF TEXAS

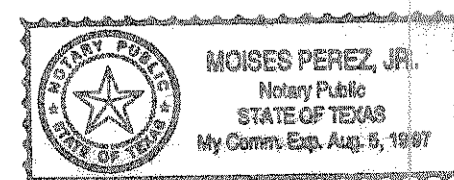

STATE OF TEXAS  
COUNTY OF NUECES

I, DAN L. URBAN, REGISTERED PROFESSIONAL LAND SURVEYOR FOR URBAN ENGINEERING, HEREBY CERTIFY THAT THE FOREGOING MAP WAS PREPARED FROM SURVEYS MADE ON THE GROUND UNDER MY DIRECTION AND IS TRUE AND CORRECT; THAT I HAVE BEEN ENGAGED UNDER CONTRACT TO SET ALL LOT AND BLOCK CORNERS AS SHOWN HEREON AND TO COMPLETE SUCH OPERATIONS WITHOUT DELAY.

THIS THE 20th DAY OF APRIL, 1994.

*Dan L. Urban*

DAN L. URBAN, R.P.L.S.  
TEXAS LICENSE NO. 4710



STATE OF TEXAS  
COUNTY OF NUECES

THIS FINAL PLAT OF THE HEREIN DESCRIBED PROPERTY WAS APPROVED BY THE DEPARTMENT OF ENGINEERING SERVICES OF THE CITY OF CORPUS CHRISTI, TEXAS.

THIS THE 4th DAY OF May, 1994.

*Carl Crull*

CARL CRULL,  
DIRECTOR OF ENGINEERING SERVICES/CITY ENGINEER

STATE OF TEXAS  
COUNTY OF NUECES

THIS FINAL PLAT OF THE HEREIN DESCRIBED PROPERTY WAS APPROVED ON BEHALF OF THE CITY OF CORPUS CHRISTI, TEXAS BY THE ZONING AND PLANNING COMMISSION.

THIS THE 1st DAY OF December, 1993.

*Brandol M. Harvey*

BRANDOL M. HARVEY,  
DIRECTOR OF PLANNING

*Shirley Mims*  
SHIRLEY MIMS, CHAIRMAN

94-033

STATE OF TEXAS  
COUNTY OF NUECES

I, ERNEST BRIONES, CLERK OF THE COUNTY COURT IN AND FOR SAID COUNTY, DO HEREBY CERTIFY THAT THE FOREGOING INSTRUMENT DATED THE 14 DAY OF April, 1994, WITH ITS CERTIFICATE OF AUTHENTICATION WAS FILED FOR RECORD IN MY OFFICE THE 4 DAY OF May, 1994, AT 3:49 O'CLOCK P. M., AND DULY RECORDED THE 5 DAY OF May, 1994, AT 9:25 O'CLOCK A. M., IN SAID COUNTY IN VOLUME 56, PAGE 62-63 MAP RECORDS.

WITNESS MY HAND AND SEAL OF THE COUNTY COURT, IN AND FOR SAID COUNTY, AT OFFICE IN CORPUS CHRISTI, TEXAS, THE DAY AND YEAR LAST WRITTEN.

NO. 908873  
FILED FOR RECORD

AT 3:49 O'CLOCK P. M.

May 4, 1994

ERNEST BRIONES  
CLERK COUNTY COURT  
NUECES COUNTY, TEXAS

*Ernest Briones*  
ERNEST BRIONES, COUNTY CLERK  
NUECES COUNTY, TEXAS

BY: *Juanita Ramirez*  
DEPUTY  
JUANITA RAMIREZ

BY: *Juanita Ramirez*  
DEPUTY  
JUANITA RAMIREZ



DATE: NOVEMBER 12, 1993  
SCALE: 1" = 100'  
JOB NO. 15552.01.01  
SHEET 1 OF 2

LOT 31 SECTION 11  
FLOUR BLUFF, ENCINAL FARM, & GARDEN TRACTS  
VOL. A, PGS. 41 - 43, M.R.N.C.T.  
MARK BRATTON

LOT 30  
MARK BRATTON

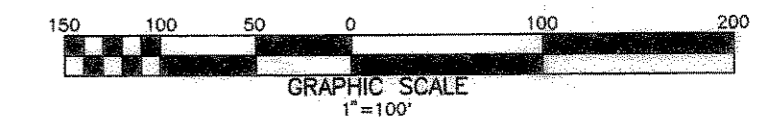
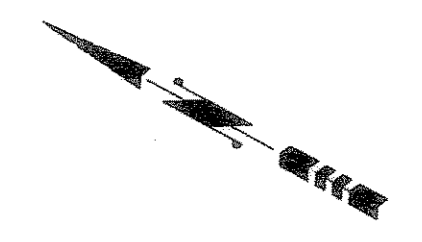

CURVE TABLE				
NUMBER	DELTA	RADIUS	LENGTH	TANGENT
C1	91°03'18"	10.00'	15.89'	10.19'
C2	88°56'42"	10.00'	15.52'	9.82'
C3	90°00'00"	10.00'	15.71'	10.00'
C4	90°00'00"	10.00'	15.71'	10.00'
C5	26°35'48"	34.50'	149.95'	8.15'
C6	143°11'36"	60.00'	149.95'	180.33'
C7	26°35'48"	34.50'	149.95'	8.15'
C8	143°11'36"	60.00'	149.95'	180.33'
C9	17°00'10"	60.00'	17.81'	8.97'
C10	49°39'23"	60.00'	52.00'	27.76'
C11	42°58'19"	60.00'	45.00'	23.62'
C12	33°33'45"	60.00'	35.15'	18.09'
C13	17°55'22"	34.50'	10.79'	5.44'
C14	8°40'27"	34.50'	5.22'	2.62'
C15	48°43'19"	60.00'	51.02'	27.17'
C16	40°31'26"	60.00'	42.44'	22.15'
C17	53°56'51"	60.00'	56.49'	30.54'
C18	0°48'39"	2274.97'	32.19'	16.10'
C19	96°45'51"	10.00'	16.89'	11.26'
C20	86°49'59"	10.00'	15.16'	9.46'
C21	32°55'51"	10.00'	16.21'	10.52'
C22	83°14'09"	10.00'	14.53'	8.88'
C23	52°25'58"	986.44'	92.67'	46.37'
C24	53°39'49"	916.44'	90.59'	45.33'
C25	2°11'18"	916.44'	35.00'	17.50'
C26	2°36'09"	986.44'	44.80'	22.41'
C27	73°7'47"	951.44'	126.70'	63.44'
C28	1°38'02"	951.44'	27.13'	13.57'
C29	90°00'50"	10.00'	15.71'	10.00'
C30	89°59'10"	10.00'	15.71'	10.00'
C31	6°43'21"	851.33'	99.89'	50.00'
C32	6°43'21"	876.33'	102.82'	51.47'
C33	6°43'21"	826.33'	96.95'	48.53'
C34	45°14'23"	34.50'	27.24'	14.37'
C35	27°28'46"	50.00'	236.04'	119.88'
C36	09°15'49"	951.44'	153.83'	77.08'

TANGENT TABLE		
NUMBER	DISTANCE	BEARING
T1	10.00'	N 61°03'20" W
T2	65.67'	N 35°42'31" E
T3	14.69'	S 61°03'20" W
T4	2.04'	S 48°03'20" W
T5	4.07'	S 49°03'20" W

No. 908873  
FILED FOR RECORD  
AT 3:49 O'CLOCK P. M.

MAY 04 1994

ERNEST M. BRIONES  
CLERK, COUNTY COURT  
NECES COUNTY, TEXAS  
BY Juanita Ramirez DEPUTY

# PLAT OF BARCLAY GROVE UNIT 1

TOTAL PLATTED AREA = 16.574 ACRES

POLASEK AGNES ET,AL

LOT 3

LOT 2 SECTION 10  
FLOUR BLUFF & ENCINAL FARM & GARDEN TRACTS  
VOL. A, PGS. 41 - 43, M.R.N.C.T.

LOT 1  
MARK BRATTON

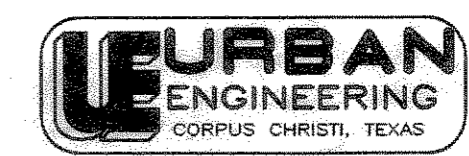

DATE: 11/12/93  
SCALE: 1" = 100'  
JOB No. 15552.01.01  
SHEET 2 OF 2