

State of Texas
 County of Nueces

I, Dan L. Urban, a Registered Professional Land Surveyor for Urban Engineering, have prepared the foregoing map from a survey made on the ground under my direction and is true and correct to the best of my knowledge, information and belief; I have been engaged under contract to set all Lot and Block corners as shown hereon and to complete such operations with due and reasonable diligence consistent with sound professional practice.

This the 29th day of SEPTEMBER, 2004

Dan L. Urban
 Dan L. Urban, R.P.L.S.
 Texas License No. 4710

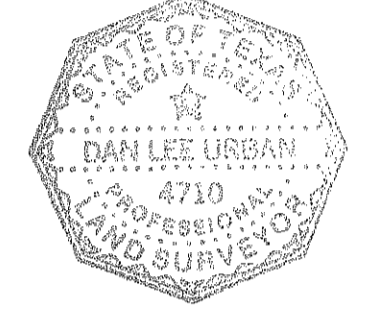

State of Texas
 County of Nueces

This final plat of the herein described property was approved by the City Engineer for the City of Port Aransas, Texas.

This the 6th day of October, 2004

Alan May #48084
 City Engineer

State of Texas
 County of Nueces

This final plat of the herein described property was approved on behalf of the City of Port Aransas, Texas by the Planning and Zoning Commission.

This the 4th day of OCTOBER, 2004

Charles Beatty
 Chairman of Planning and Zoning Commission

Zethor Arzola
 City Secretary



State of Texas
 County of Nueces

This final plat of the herein described property was approved on behalf of the City of Port Aransas, Texas by the City Council.

This the 4th day of October, 2004

Georgia Nettles
 Mayor

Zethor Arzola
 City Secretary

State of Texas
 County of Nueces

I, Diana Barrera, Clerk of the County Court in and for said County, do hereby certify that the foregoing instrument dated the 6th day of October, 2004, with its certificate of authentication was filed for record in my office the 6th day of October, 2004. At 3:19 O'clock P.M., and duly recorded the 6th day of October, 2004, at 3:19 O'clock P.M., in said County in Volume 144, Page 4, Map Records.

Witness my hand and seal of the County Court, in and for said County, at office in Corpus Christi, Texas, the day and year last written.

No. 2004052141
 Filed for Record
 at 3:19 O'clock P.M.,
October 6, 2004

Diana J. Barrera
 Diana Barrera, County Clerk
 Nueces County, Texas
 By: Pamela B. Arriaga
 Deputy

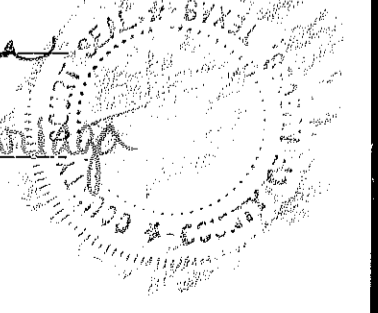

Diana Barrera
 Clerk County Court
 Nueces County, Texas

By: Pamela B. Arriaga
 Deputy

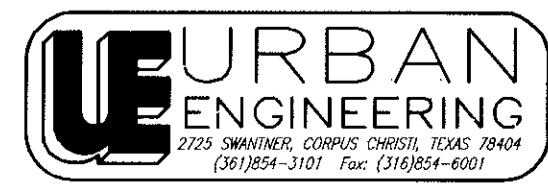

DATE: SEPT. 28, 2004
 SCALE: 1" = 40'
 JOB NO.: 39611.00.00
 SHEET: 1 OF 1
 DRAWN BY: RR

State of Texas
 County of Nueces

I, R. MARK GROSSE, hereby certify that I am the owner of the lands embraced within the boundaries of the foregoing plat; that I have had said lands surveyed and subdivided as shown; that streets shown are dedicated to the public use forever; that easements as shown are dedicated to the public use for the installation, operation and use of public utilities; and that this map was made for the purpose of description and dedication.

This the 1st day of October, 2004

By: R. Mark Grosse
 R. MARK GROSSE

State of Texas
 County of Nueces

This instrument was acknowledged before me by R. MARK GROSSE.

This the 1st day of October, 2004

Vanessa Brundrett
 Notary Public in and for the State of Texas



Plat of
Shore Leave Addition
Block 1, Lot 1

1.555 acres of out of Lots 1 and 2, Block 73, State Land Surveys on Mustang Island, Port Aransas, Texas, a map of which is recorded in the General Land Office in Austin, Texas.

- Notes:**
- 1.) Total platted area contains 1.555 acres of land. (Includes Steet Dedication)
 - 2.) By graphic plotting only, this property is in Zone "AE (EL 8)" on Flood Insurance Rate Map, Community Panel No. 485498 0003 F, City of Port Aransas, Texas, which bears an effective date of September 30, 1992 and is in a Special Flood Hazard Area.

V64 P4