

- Notes:**
- 1.) Total platted area contains 0.285 acres (12,415.57 square feet) of land. (Includes Street Dedication)
  - 2.) Bearings are based on the northwest boundary of Lot 2, Port Aransas Marina, same being the southeast boundary of this plat and shown as South 50°45'00\"/>

0.285 acres (12,415.57 square feet) of land being all of Lot 1, Port Aransas Marina, a map of which is recorded in Volume 24, Page 27, Map Records of Nueces County, Texas; and 0.157 acres out of the William Little Survey No. 20, Abstract 216, located on Mustang Island, Port Aransas, Texas; said 0.157 acres of land being described by Warranty Deed recorded in Document No. 1998011295, Official Public Records of Nueces County, Texas.

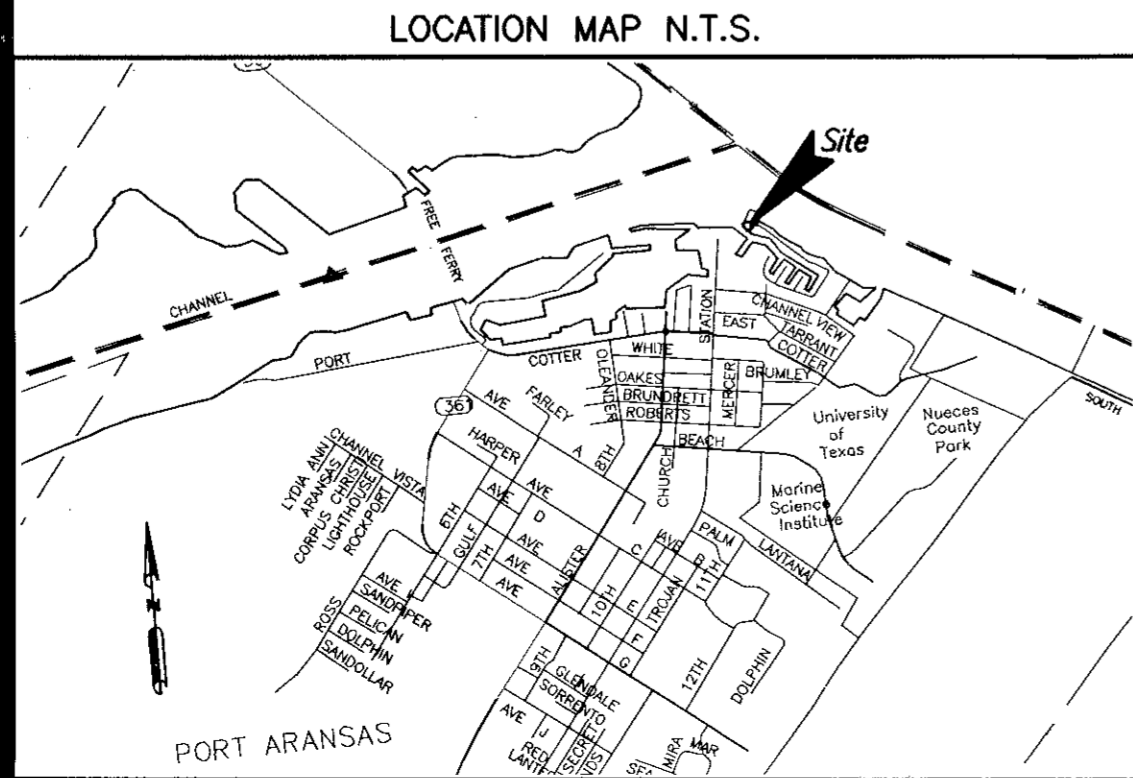

State of Texas  
County of Nueces

WILLARD HAMMONDS TRUSTEE, hereby certify that it is the owner of the lands embraced within the boundaries of the foregoing plat; that it has had said lands surveyed and subdivided as shown; that easements as shown are dedicated to the public use for the installation, operation and use of public utilities; and that this map was made for the purpose of description and dedication.

This the 16<sup>th</sup> day of February, 2004

By: [Signature]  
WILLARD H. HAMMONDS, II, TRUSTEE

State of Texas  
County of Nueces

This instrument was acknowledged before me by WILLARD H. HAMMONDS, II, as TRUSTEE OF WILLARD HAMMONDS TRUST.

This the 16<sup>th</sup> day of February, 2004

[Signature]  
Notary Public in and for the State of Texas

State of Texas  
County of Nueces

I, Dan L. Urban, a Registered Professional Land Surveyor for Urban Engineering, have prepared the foregoing map from a survey made on the ground under my direction and is true and correct to the best of my knowledge, information and belief; I have been engaged under contract to set all Lot and Block corners as shown hereon and to complete such operations with due and reasonable diligence consistent with sound professional practice.

This the 6<sup>th</sup> day of FEBRUARY, 2004

[Signature]  
Dan L. Urban, R.P.L.S.  
Texas License No. 4710

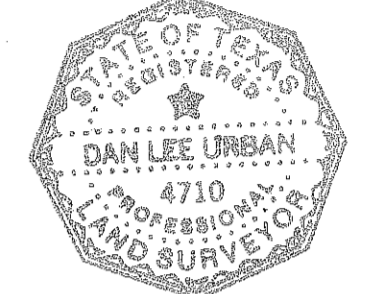

State of Texas  
County of Nueces

This final plat of the herein described property was approved by the City Engineer for the City of Port Aransas, Texas.

This the 31<sup>st</sup> day of March, 2004

[Signature] #48084  
City Engineer

State of Texas  
County of Nueces

This final plat of the herein described property was approved on behalf of the City of Port Aransas, Texas by the Planning and Zoning Commission.

This the 28<sup>th</sup> day of March, 2004

[Signature] #48084  
Chairman of Planning and Zoning Commission

[Signature]  
City Secretary

State of Texas  
County of Nueces

This final plat of the herein described property was approved on behalf of the City of Port Aransas, Texas by the City Council.

This the 23 day of March, 2004

[Signature]  
Mayor

[Signature]  
City Secretary



State of Texas  
County of Nueces

I, Ernest Briones, Clerk of the County Court in and for said County, do hereby certify that the foregoing instrument dated the 16 day of February, 2004, with its certificate of authentication was filed for record in my office the 5 day of April, 2004, at 2:05 O'clock P.M., and duly recorded the 5 day of April, 2004, at 2:05 O'clock P.M., in said County in Volume 63, Page 101, Map Records.

Witness my hand and seal of the County Court, in and for said County, at office in Corpus Christi, Texas, the day and year last written.

No. 2004016100  
Filed for Record

at 2:05 O'clock P.M.,  
April 5, 2004

[Signature]  
Ernest Briones, County Clerk  
Nueces County, Texas

[Signature]  
Deputy

[Signature]  
Ernest Briones  
Clerk County Court  
Nueces County, Texas

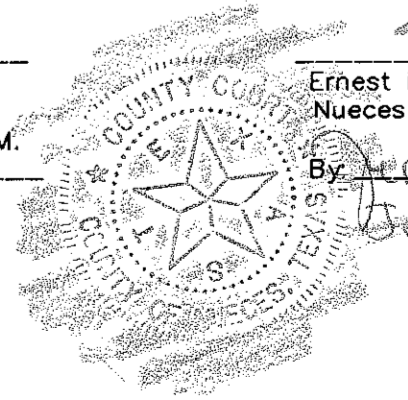

By: [Signature]  
Deputy  
[Signature]

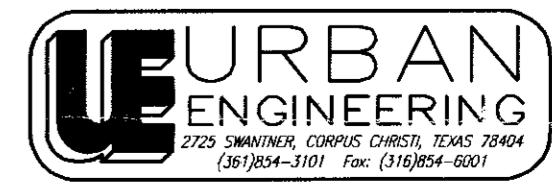

DATE: FEB. 6, 2004  
SCALE: 1" = 20'  
JOB NO.: 39358.00.00  
SHEET: 1 OF 1  
DRAWN BY: RR