

- Notes:
- 1.) Total platted area contains 1.821 acres of land.
  - 2.) Bearings based on the recorded plat of Sea Gull Isle, a map of which is recorded in Volume 32, Page 108, Map Records of Nueces County, Texas.
  - 3.) By graphic plotting only, this property is in Zone "AE (EL 8)" and "X" of the Flood Insurance Rate Map, Community Panel Number 485498 0003 F, City of Port Aransas, Texas, which bears an effective date of September 30, 1992 and is partially in a Special Flood Hazard Area.

**Plat of  
Island Villas  
Lot 1A, Block 1**

Being a replat of Lots 1, Block 1, Island Villas, a map of which is recorded in Volume 64, Page 213, Map Records of Nueces County, Texas.

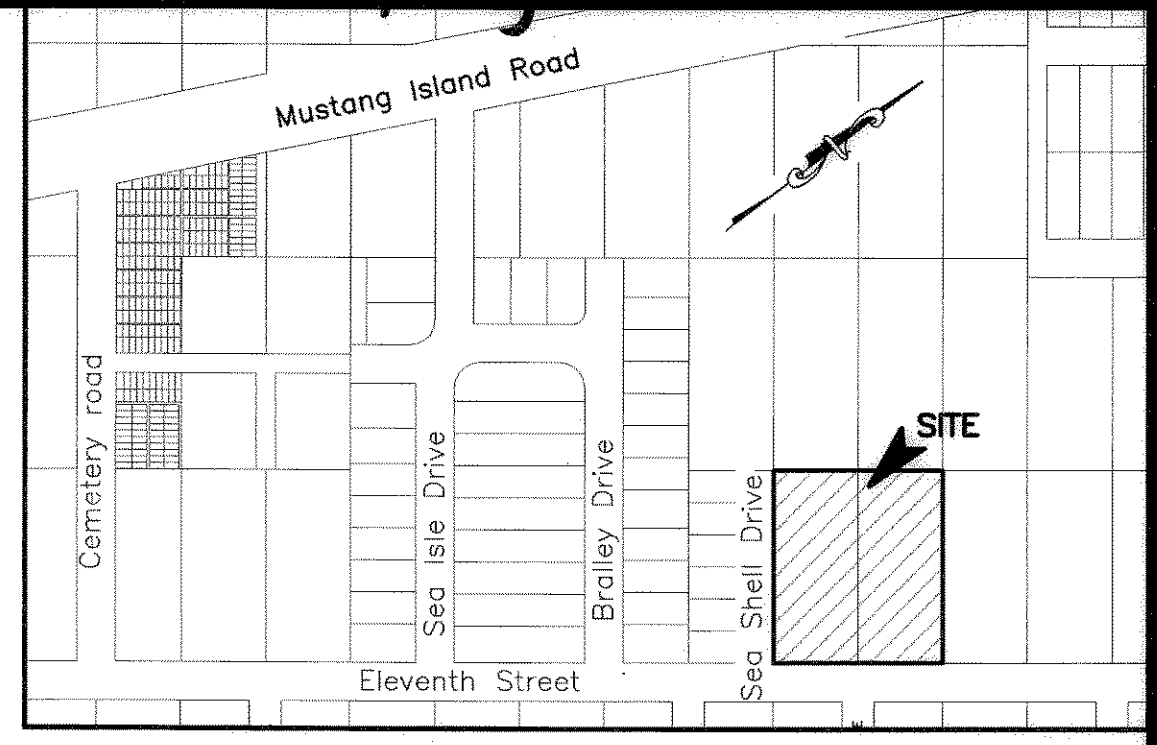

State of Texas  
County of Nueces

I, Dan L. Urban, a Registered Professional Land Surveyor for Urban Engineering, have prepared the foregoing map from a survey made on the ground under my direction and is true and correct to the best of my knowledge, information and belief; I have been engaged under contract to set all Lot and Block corners as shown hereon and to complete such operations with due and reasonable diligence consistent with sound professional practice.

This the 2ND day of APRIL 2007  
*[Signature]*  
 Dan L. Urban, R.P.L.S.  
 Texas License No. 4710



State of Texas  
County of Nueces

This final plat of the herein described property was approved by the City Engineer for the City of Port Aransas, Texas.

This the 2ND day of APRIL 2007  
*[Signature]*  
 City Engineer

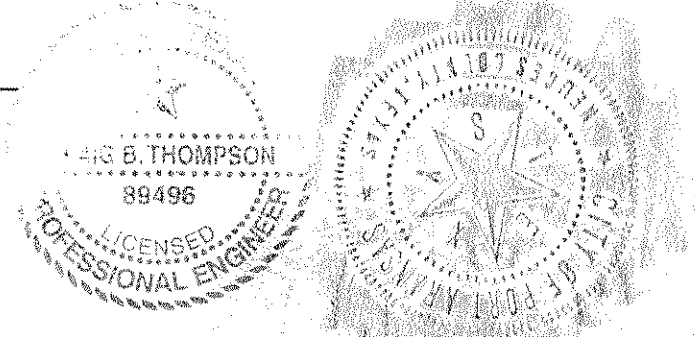

State of Texas  
County of Nueces

This final plat of the herein described property was approved on behalf of the City of Port Aransas, Texas by the Building Official.

This the 27th day of MARCH 2007  
*[Signature]*  
 City Building Official

State of Texas  
County of Nueces

I, Diana T. Barrera, Clerk of the County Court in and for said County, do hereby certify that the foregoing instrument dated the 23rd day of MARCH, 2007, with its certificate of authentication was filed for record in my office the 3rd day of APRIL, 2007, AT 3:42 O'clock P.M., and duly recorded the 2nd day of APRIL, 2007, at 3:42 O'clock P.M., in said County in Volume 66, Page 132 & 133, Map Records.

Witness my hand and seal of the County Court, in and for said County, at office in Corpus Christi, Texas, the day and year last written.

No. 2007017155  
 Filed for Record  
 at 3:42 O'clock P.M.  
April 3 2007

*[Signature]*  
 Diana T. Barrera, County Clerk  
 Nueces County, Texas  
 By: *[Signature]*  
 Deputy  
 Edwina Elizondo

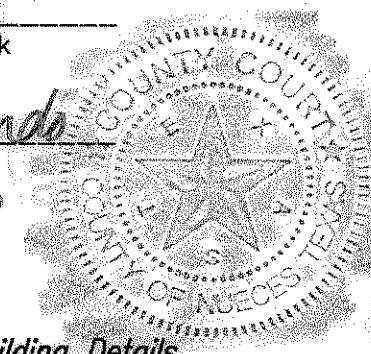

See sheet 2 of 2 for Building Details

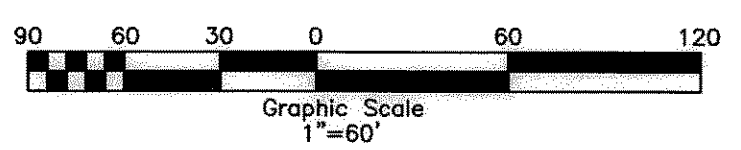

**URBAN ENGINEERING**  
 2725 SWINNER, CORPUS CHRISTI, TEXAS 78404  
 (361)854-3101 Fax: (361)854-6001

DATE: March 1, 2007  
 SCALE: 1"=60'  
 JOB NO.: 37431.A7.00  
 SHEET: 1 of 2  
 DRAWN BY: XG

State of Texas  
County of Nueces

We, Sea Shell Village Associates, LLC, hereby certify that we are the owner of the lands embraced within the boundaries of the foregoing plat; that we have had said lands surveyed and subdivided as shown; that easements as shown are dedicated to the public use for the installation, operation and use of public utilities; and that this map was made for the purpose of description and dedication.

This the 22nd day of MARCH 2007

By: Sea Shell Village Associates, LLC  
*[Signature]*  
 Kathleen Perry, Manager

State of Texas  
County of Nueces

This instrument was acknowledged before me by Kathleen Perry, as Manager of Sea Shell Village Associates, LLC

This the 23 day of MARCH 2007

*[Signature]*  
 Notary Public in and for the State of Texas

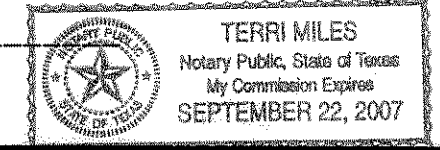

State of Texas  
County of Nueces

Mission Mortgage of Texas, Inc., hereby certifies that it holds a lien on the property owned by Seashell Village Associates, LLC, as shown on the foregoing map and it approves of the subdivision and dedication for the purposes and considerations therein expressed.

This the 23rd day of MARCH 2007

By: Mission Mortgage of Texas, Inc.  
*[Signature]*  
 Lee Ann McCoy, President

State of Texas  
County of Nueces

This instrument was acknowledged before me by Lee Ann McCoy as President of Mission Mortgage of Texas, Inc.

This the 23 day of MARCH 2007

*[Signature]*  
 Notary Public in and for the State of Texas

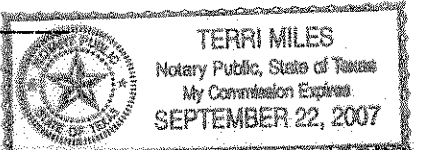

Notes:

- 1.) Total platted area contains 1.821 acres of land.
- 2.) Bearings based on the recorded plat of Sea Gull Isle, a map of which is recorded in Volume 32, Page 108, Map Records of Nueces County, Texas.
- 3.) By graphic plotting only, this property is in Zone "AE (EL 8)" and "X" of the Flood Insurance Rate Map, Community Panel Number 485498 0003 F, City of Port Aransas, Texas, which bears an effective date of September 30, 1992 and is partially in a Special Flood Hazard Area.

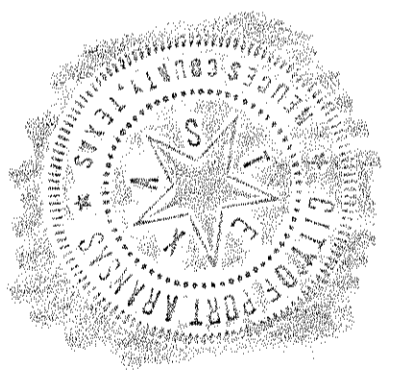
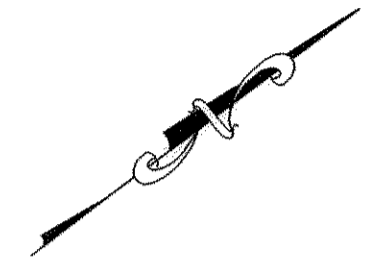
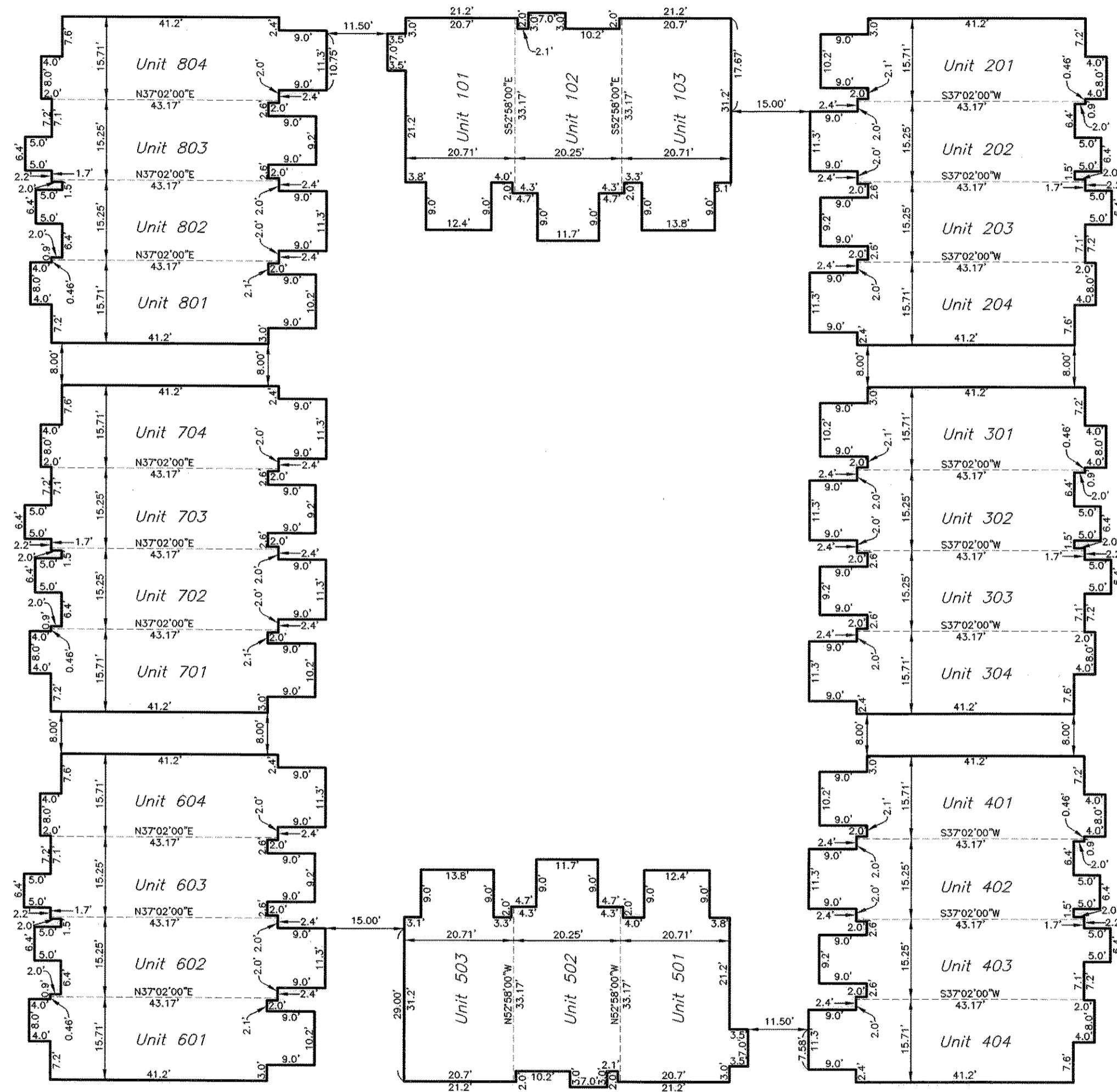

Building Details

Plat of  
Island Villas  
Lot 1A, Block 1

Being a replat of Lots 1, Block 1, Island Villas, a map of which is recorded in Volume 64, Page 213, Map Records of Nueces County, Texas.

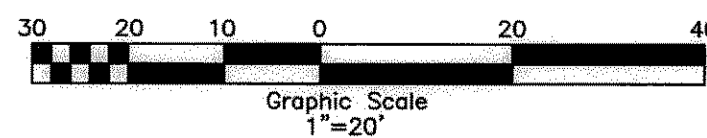

**URBAN ENGINEERING**  
 2725 SWANTHER, CORPUS CHRISTI, TEXAS 78404  
 (361)854-3101 Fax: (361)854-8001

DATE: March 1, 2007  
 SCALE: 1"=20'  
 JOB NO.: 37431.A7.00  
 SHEET: 2 of 2  
 DRAWN BY: XG