

LINE	BEARING	DISTANCE
L1	N83°10'30"W	53.99'
L2	N28°59'23"E	45.00'
L3	N29°01'36"E	10.02'
L4	S28°34'14"W	14.25'
L5	S16°25'46"E	57.43'
L6	S61°25'46"E	41.73'
L7	S28°34'14"W	99.56'
L8	S16°25'46"E	6.16'
L9	S28°34'14"W	95.73'
L10	S73°34'14"W	7.77'
L11	N28°58'20"E	31.44'
L12	N73°34'14"E	7.70'
L13	N28°34'14"E	83.31'
L14	N16°25'46"W	6.16'
L15	N28°34'14"E	90.77'
L16	N61°25'46"W	32.95'
L17	N16°25'46"W	69.85'
L18	N28°34'14"E	20.47'

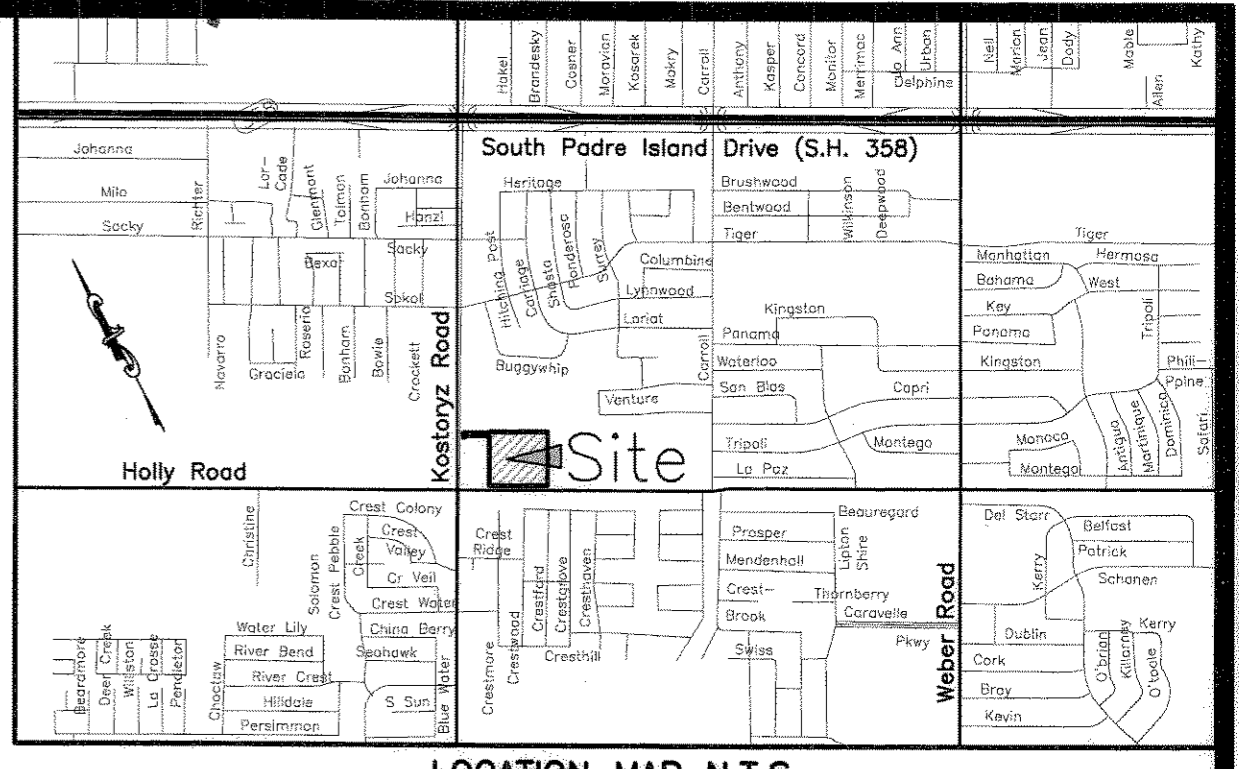

State of Texas
County of Nueces

I, Dan L. Urban, a Registered Professional Land Surveyor for Urban Engineering, have prepared the foregoing map from a survey made on the ground under my direction and is true and correct to the best of my knowledge, information and belief; I have been engaged under contract to set all Lot and Block corners as shown hereon and to complete such operations with due and reasonable diligence consistent with sound professional practice.

This the 22nd day of JANUARY, 2008
Dan L. Urban
 Dan L. Urban, R.P.L.S.
 Texas License No. 4710



State of Texas
County of Nueces

This final plat of the herein described property was approved by the Department of Development Services of the City of Corpus Christi, Texas.

This the 14th day of February, 2008
Juan Perales, Jr.
 Juan Perales, Jr., P.E.
 Development Services Engineer

State of Texas
County of Nueces

This final plat of the herein described property was approved on behalf of the City of Corpus Christi, Texas by the Planning Commission.

This the 19th day of SEPTEMBER, 2007
Faryce Goode-Macon
 Faryce Goode-Macon
 Secretary
 0907124-NP079
R. Bryan Stone
 R. Bryan Stone, Chairman

State of Texas
County of Nueces

I, Diana T. Barrera, Clerk of the County Court in and for said County, do hereby certify that the foregoing instrument dated the 22nd day of January, 2008, with its certificate of authentication was filed for record in my office the 15th day of February, 2008. At 3:07 O'clock P.M., and duly recorded in the 15th day of February, 2008, at 3:07 O'clock P.M., in said County in Volume 67, Page 106, Map Records.

Witness my hand and seal of the County Court, in and for said County, at office in Corpus Christi, Texas, the day and year last written.

No. 2008006961
 Filed for Record
 at 3:07 O'clock P.M.
February 15, 2008

Diana T. Barrera
 Diana T. Barrera, County Clerk
 Nueces County, Texas
 By: *Edvinia Ramirez*
 Deputy

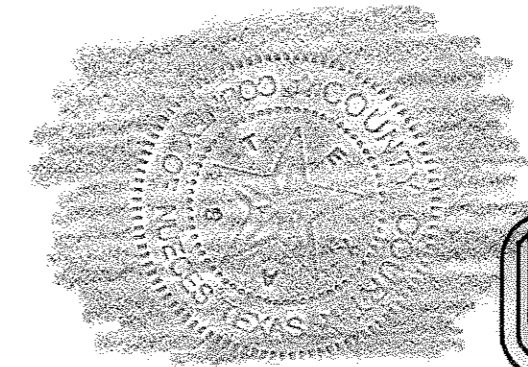

URBAN ENGINEERING
 2725 SWATHUR, CORPUS CHRISTI, TEXAS 78404
 (361)854-3101 Fax (361)854-8001
 DATE: August 17, 2007
 SCALE: 1"=100'
 JOB NO.: 41177.00.01
 SHEET: 1 of 1
 DRAWN BY: XG

State of Texas
County of Nueces

The Joslin Partnership, Ltd., hereby certifies that it is the owner of the lands embraced within the boundaries of the foregoing plat; that it has had said lands surveyed and subdivided as shown; that easements as shown are dedicated to the public use for the installation, operation and use of public utilities; and that this map was made for the purpose of description and dedication.

This the 22nd day of January, 2008

By: *Joseph A. Newcomb*
 Joseph A. Newcomb, Vice-President and Trust Officer Wells Fargo Bank, National Association Successor Independent Executor of the Estate of Ennis S. Joslin, Deceased, Its Managing General Partner

State of Texas
County of Nueces

This instrument was acknowledged before me by Joseph A. Newcomb, as a Vice-President and Trust Officer Wells Fargo Bank, National Association Successor Independent Executor of the Estate of Ennis S. Joslin, Deceased Its Managing General Partner.

This the 22nd day of January, 2008
Angela Cook
 Notary Public in and for the State of Texas

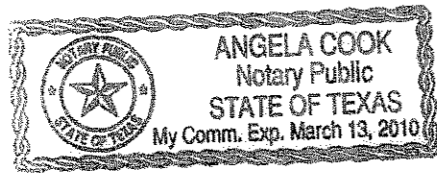

Plat of
Holly Park
 Block 1, Lot 2, 3 and 4

being 7.865 acres of land out of Lot 5, Section 2, Bohemian Colony Lands, a map of which is recorded in Volume A, Page 48, Map Records of Nueces County, Texas.

Notes:

- Total platted area contains 7.865 acres of land.
- Set 5/8 inch iron rods with red plastic cap stamped "URBAN ENGR C.C. TX" at all Lot corners, except where noted.
- The receiving waters for storm water runoff is the Oso Creek Basin. The TCEQ has not classified the aquatic life use for the Oso Creek, but it is recognized as an environmentally sensitive area. The Oso Creek flows directly into the Oso Bay. The TCEQ has classified the aquatic life use for Oso Bay as "exceptional" and "oyster waters" and categorized the receiving water as "contact recreation" use.
- Bearings are based on the recorded plat of Lot 1, Block 1, Holly Park, a map of which is recorded in Volume 62, Pages 116-117, Map Records of Nueces County, Texas.
- By graphic plotting only, this property is in Zone "C" of the Flood Insurance Rate Map, Community Panel Number 485464 0285 C, a non-printed panel, City of Corpus Christi, Texas, which bears an effective date of September 17, 1992 and is not in a Special Flood Hazard Area.
- If any lot is developed with residential uses, a park settlement fee shall be required at the building permit phase.