

- Notes:
- Total platted area contains 7.462 acres of land.
  - Set 5/8 inch iron rods with red plastic cap stamped "URBAN ENGR C.C. TX" at all Lot corners, except where noted.
  - The receiving waters for storm water runoff is the Laguna Madre Basin. The TCEQ has classified the aquatic life use for Laguna Madre as "exceptional" and "oyster waters" and TCEQ also categorized the Laguna Madre as "contact recreation" use.
  - Bearings are based on the recorded plat of Blocks D2, D4, D5, D6, D7, D8 and D9, Laguna Business Center, a map of which is recorded in Volume 52, Pages 26-27, Map Records of Nueces County, Texas.
  - By graphic plotting only, this property is in Zone "C" on Flood Insurance Rate Map, Community Panel No. 485464 0316 C, City of Corpus Christi, Texas, which bears an effective date of July 18, 1985 and it is not in a Special Flood Hazard Area.
  - All lots are subject to an existing Access Easement Reciprocal Development and operating Agreement. (Doc. # 2108027886)
  - Block D9 is reserved for Storm Water Detention until offsite storm sewer has adequate capacity.
  - Vehicle Access across lot lines shall not be obstructed.
  - The owner of Block D9 is responsible for the maintenance of the private drainage facility located within Block D9.

**Plat of  
Laguna Business Center  
Block D8, Lots 1, 2 and 3**

being a replat of Block D8, Laguna Business Center, a map of which is recorded in Volume 52, Pages 26-27, Map Records of Nueces County, Texas.

State of Texas  
County of Travis

CVC FB LP, a Limited Partnership, hereby certifies that it is the owner of the lands embraced within the boundaries of the foregoing plat; that it has had said lands surveyed and subdivided as shown; that streets shown are dedicated to the public use forever; that easements as shown are dedicated to the public use for the installation, operation and use of public utilities; and that this map was made for the purpose of description and dedication.

This the 21st day of July, 2008

By: CVC FB LP, a Limited Partnership  
*Chris Cox*  
Chris Cox, President

State of Texas  
County of Travis

This instrument was acknowledged before me by Chris Cox, as President of CVC FB LP, a Limited Partnership, on behalf of said partnership.

This the 21st day of July, 2008

*Raquel Saenz*  
Raquel Saenz  
Notary Public in and for the State of Texas  
My Commission Expires 05-04-2011

State of Texas  
County of Travis

First National Bank, hereby certifies that it holds a lien on the property owned by CVC FB LP, a Limited Partnership, as shown on the foregoing map and it approves of the subdivision and dedication for the purposes and considerations therein expressed.

This the 24th day of July, 2008

By: First National Bank  
*Robert Gandy*  
Robert Gandy, Branch Manager

State of Texas  
County of Travis

This instrument was acknowledged before me by Robert Gandy, as Branch Manager of First National Bank, on behalf of said bank.

This the 24th day of July, 2008

*Raquel Saenz*  
Raquel Saenz  
Notary Public in and for the State of Texas

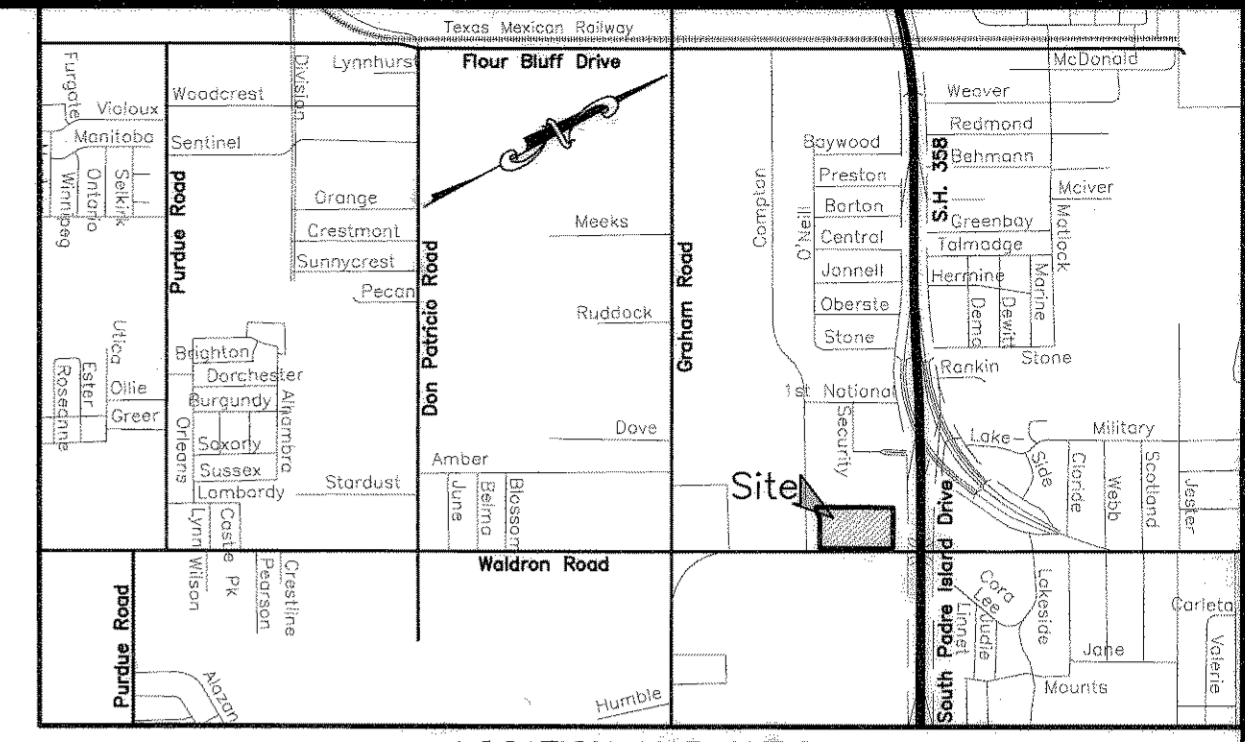

LINE	BEARING	DISTANCE
L1	N61°00'00"W	23.21'

State of Texas  
County of Nueces

Dan L. Urban, a Registered Professional Land Surveyor for Urban Engineering, have prepared the foregoing map from a survey made on the ground under my direction and is true and correct to the best of my knowledge, information and belief; I have been engaged under contract to set all Lot and Block corners as shown hereon and to complete such operations with due and reasonable diligence consistent with sound professional practice.

This the 21th day of AUGUST, 2008

*Dan L. Urban*  
Dan L. Urban, R.P.L.S.  
Texas License No. 4710

State of Texas  
County of Nueces

This final plat of the herein described property was approved by the Department of Development Services of the City of Corpus Christi, Texas.

This the 19 day of AUGUST, 2008

*Juan Perales, Jr.*  
Juan Perales, Jr., P.E.  
Development Services Engineer



State of Texas  
County of Nueces

This final plat of the herein described property was approved on behalf of the City of Corpus Christi, Texas by the Planning Commission.

This the 19 day of May, 2008

*Faryce Opode-Macon*  
Faryce Opode-Macon  
Secretary  
0508044-NP034

*Rudy Garza*  
Rudy Garza, Chairman

State of Texas  
County of Nueces

I, Diana T. Barrera, Clerk of the County Court in and for said County, do hereby certify that the foregoing instrument dated the 20 day of August, 2008, with its certificate of authentication was filed for record in my office the 20 day of August, 2008, at 1:04 O'clock P.M., and duly recorded the 20 day of August, 2008, at 1:04 O'clock P.M., in said County in Volume 67, Page 207, Map Records.

Witness my hand and seal of the County Court, in and for said County, at office in Corpus Christi, Texas, the day and year last written.

No. 2008 037 598  
Filed for Record

at 1:04 O'clock P.M.,  
August 20, 2008

*Diana T. Barrera*  
Diana T. Barrera, County Clerk  
Nueces County, Texas

By: *Gracie Barrera*  
Gracie Barrera  
Deputy

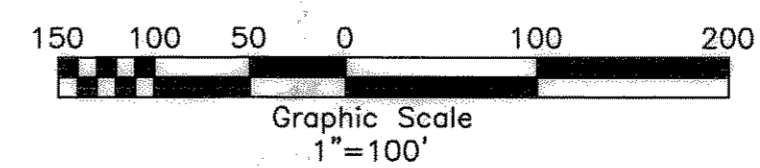

**URBAN ENGINEERING**  
2725 SHANNON, CORPUS CHRISTI, TEXAS 78404  
(361)854-3101 Fax: (361)854-0901

DATE: April 23, 2008  
SCALE: 1"=100'  
JOB NO.: 01300.A8.00  
SHEET: 1 of 1  
DRAWN BY: XG

Vol. 67 P. 207