

State of Texas
County of Nueces

I, Dan L. Urban, a Registered Professional Land Surveyor for Urban Engineering, have prepared the foregoing map from a survey made on the ground under my direction and is true and correct to the best of my knowledge, information and belief; I have been engaged under contract to set all Lot and Block corners as shown hereon and to complete such operations with due and reasonable diligence consistent with sound professional practice.

This the 18th day of MAY, 2005
Dan L. Urban
Dan L. Urban, R.P.L.S.
Texas License No. 4710

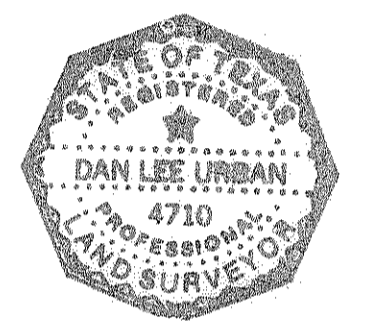

State of Texas
County of Nueces

This final plat of the herein described property was approved by the Department of Engineering Services of the City of Corpus Christi, Texas.

This the 5th day of July, 2005
Angel R. Escobar PE
Angel R. Escobar, P.E./R.P.L.S.
Director of Engineering Services

State of Texas
County of Nueces

This final plat of the herein described property was approved on behalf of the City of Corpus Christi, Texas by the Planning Commission.

This the 15th day of December, 2004
Michael N. Gunning
Michael N. Gunning
Secretary
1204200-999
David Berlanga Sr.
David Berlanga, Sr., Chairman

State of Texas
County of Nueces

I, Diana T. Barrera, Clerk of the County Court in and for said County, do hereby certify that the foregoing instrument dated the 18th day of May, 2005, with its certificate of authentication was filed for record in my office the 16th day of July, 2005, at 4:39 O'clock P.M., and duly recorded the 16th day of July, 2005, at 4:39 O'clock P.M., in said County in Volume 64, Page 194, Map Records.

Witness my hand and seal of the County Court, in and for said County, at office in Corpus Christi, Texas, the day and year last written.

No. 2005034241
Filed for Record
at 4:39 O'clock P.M.
July 6, 2005

Diana T. Barrera
Diana T. Barrera, County Clerk
Nueces County, Texas
By: *Pamela P. Coviega*
Deputy

Diana T. Barrera
Clerk County Court
Nueces County, Texas

By: *Pamela P. Coviega*
Deputy

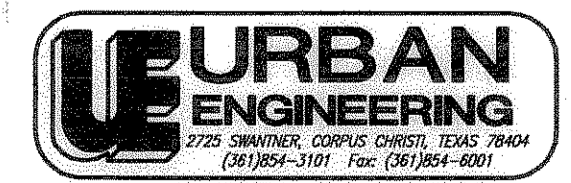

DATE: DEC. 14, 2004
SCALE: 1" = 60'
JOB NO.: 39664.00.01
SHEET: 1 OF 1
DRAWN BY: RR

State of Texas
County of Nueces

MESSIANIC FELLOWSHIP CHURCH OF CORPUS CHRISTI, a Texas Nonprofit Corporation, hereby certifies that it is the owner of the lands embraced within the boundaries of the foregoing plat; that it has had said lands surveyed and subdivided as shown; that streets shown are dedicated to the public use forever; that easements as shown are dedicated to the public use for the installation, operation and use of public utilities; and that this map was made for the purpose of description and dedication.

This the 18th day of May, 2005

By: *Bob Jones*
MESSIANIC FELLOWSHIP CHURCH OF CORPUS CHRISTI
a Texas Nonprofit Corporation
Bob Jones, Pastor

State of Texas
County of Nueces

This instrument was acknowledged before me by BOB JONES, as Pastor of MESSIANIC FELLOWSHIP CHURCH OF CORPUS CHRISTI, a Texas Nonprofit Corporation, on behalf of said corporation.

This the 19th day of May, 2005

Susan G. Tanny
Notary Public in and for the State of Texas

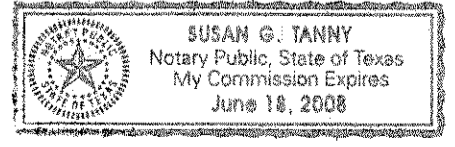

Notes:

- 1.) Total platted area contains 1.857 acres (80,892.22 square feet) of land.
- 2.) The receiving waters for storm water runoff is the Corpus Christi Inner Harbor Basin. The TCEQ has classified the aquatic life use for the Corpus Christi Inner Harbor as "intermediate".
- 3.) Bearings are based on the recorded plat of Driscoll Village, a map of which is recorded in Volume 12, Page 43, Map Records of Nueces County, Texas.
- 4.) By graphic plotting only, this property is in Zone "C" on Flood Insurance Rate Map, Community Panel No. 485464 0166 C, City of Corpus Christi, Texas, which bears an effective date of July 18, 1985 and is not in a Special Flood Hazard Area.

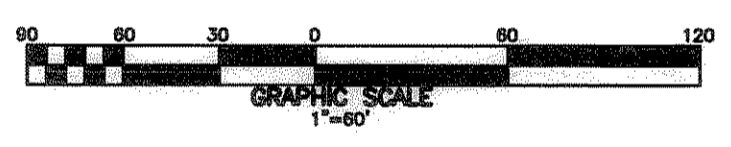

Vol: 64 Pg: 194

Vol: 64 Pg: 194