

K.R.Y.S. Tract
Vol. 29, Pg. 83, Map
Records of Nueces County, Texas

N89°52'20"E 590.47'

Lot 10
3.470 Acres
(151,131.95 sf)

S89°53'00"W 495.42'

Lot 9
2.227 Acres
(97,031.94 sf)

N88°40'59"W 495.73'

Lot 8A
McBride Commercial Sites
Vol. 44, Pg. 46, Map
Records of Nueces County, Texas

Lot 7
McBride Commercial Sites
Vol. 42, Pg. 177, Map
Records of Nueces County, Texas

Lot 6
McBride Commercial Sites
Vol. 37, Pg. 19, Map
Records of Nueces County, Texas

Block 1, Lot 1-R
Corpus Christi Greyhound
Racing Associates Tract
Vol. 54, Pgs. 131-132, Map
Records of Nueces County, Texas

Lot 5
McBride Commercial Sites
Vol. 28, Pg. 82, Map
Records of Nueces County, Texas

- Notes:
- 1.) Total platted area contains 5.697 acres of land.
 - 2.) Set 5/8 inch iron rods with red plastic cap stamped "URBAN ENGR C.C. TX" at all Lot corners, except where noted.
 - 3.) The receiving waters for storm water runoff is the Corpus Christi Inner Harbor Basin. The TCEQ has classified the aquatic life use for the Corpus Christi Inner Harbor as "intermediate".
 - 4.) Bearings are based on the recorded plat of McBride Commercial Sites, Lots 9 and 10, a map of which is recorded in Volume 58, Page 82, Map Records of Nueces County, Texas.
 - 5.) By graphic plotting only, this property is in Zone "C" on Flood Insurance Rate Map, Community Panel No. 485464 0165 C, City of Corpus Christi, Texas, which bears an effective date of July 18, 1985 and is not in a Special Flood Hazard Area.

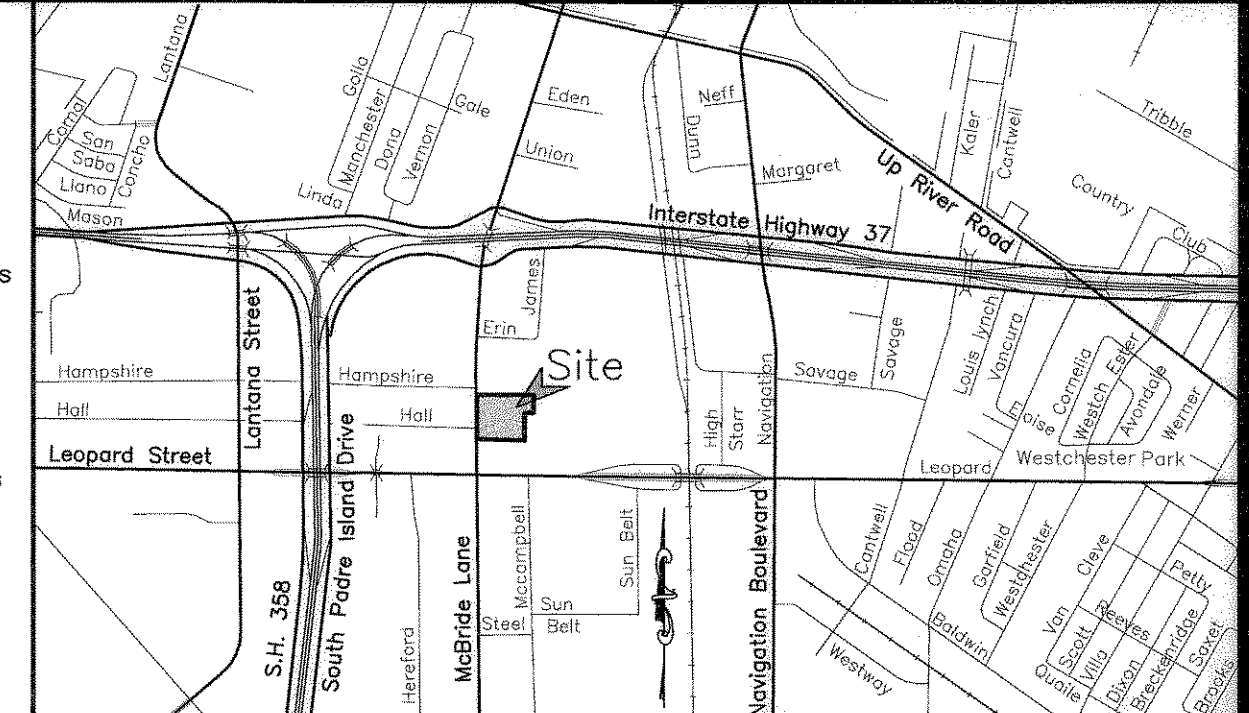

LOCATION MAP N.T.S.

Amending Plat of
McBride Commercial Sites
Lots 9 and 10

being a replat of Lots 9 and 10, McBride Commercial Sites, a map of which is recorded in Volume 58, Page 82, Map Records of Nueces County, Texas.

State of Texas
County of Nueces

I, Dan L. Urban, a Registered Professional Land Surveyor for Urban Engineering, have prepared the foregoing map from a survey made on the ground under my direction and is true and correct to the best of my knowledge, information and belief; I have been engaged under contract to set all Lot and Block corners as shown hereon and to complete such operations with due and reasonable diligence consistent with sound professional practice.

This the 4TH day of AUGUST 2006

Dan L. Urban
Dan L. Urban, R.P.L.S.
Texas License No. 4710

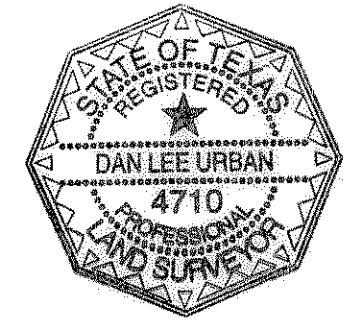

State of Texas
County of Nueces

This final plat of the herein described property was approved by the Department of Development Services of the City of Corpus Christi, Texas.

This the 26th day of February 2007

Juan Peroles, Jr.
Juan Peroles, Jr., P.E.
Acting Development Services Engineer

State of Texas
County of Nueces

This final plat of the herein described property was approved on behalf of the City of Corpus Christi, Texas by the Director of Planning.

This the 26th day of February 2007

Fayce Goode-Macon
Fayce Goode-Macon
Acting Assistant Director of Planning
0806147-NP78A26

State of Texas
County of Nueces

I, Diana T. Borrera, Clerk of the County Court, in and for said County, do hereby certify that the foregoing instrument dated the 21 day of February, 2007, with its certificate of authentication was filed for record in my office the 21 day of February, 2007 at 9:43 O'clock A. M., and duly recorded the 21 day of February, 2007, at 9:43 O'clock A. M., in said County in Volume 66, Page 114, Map Records.

Witness my hand and seal of the County Court, in and for said County, at office in Corpus Christi, Texas, the day and year last written.

No. 2007010458
Filed for Record
at 9:43 O'clock A. M.
February 21 2007

Diana T. Borrera
Diana T. Borrera, County Clerk
Nueces County, Texas
By: *Norma Handy*
Norma Handy, Deputy

State of Texas
County of Nueces

THOMAS S. DAVIS, hereby certifies that he is the owner of the lands embraced within the boundaries of Lot 9 as shown on the foregoing plat; that he has had said lands surveyed and subdivided as shown; that streets shown are dedicated to the public use forever; that easements as shown are dedicated to the public use for the installation, operation and use of public utilities; and that this map was made for the purpose of description and dedication.

This the 7th day of February 2007

By: THOMAS S. DAVIS
Thomas S. Davis
THOMAS S. DAVIS

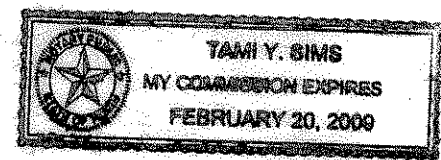

State of Texas
County of Nueces

This instrument was acknowledged before me by THOMAS S. DAVIS.

This the 7th day of February 2007

Tami Y. Sims
Notary Public in and for the State of Texas

State of Texas
County of Nueces

William Robert Johnson, hereby certifies that he is the owner of the lands embraced within the boundaries of Lot 10 as shown on the foregoing plat; that he has had said lands surveyed and subdivided as shown; that streets shown are dedicated to the public use forever; that easements as shown are dedicated to the public use for the installation, operation and use of public utilities; and that this map was made for the purpose of description and dedication.

This the 7th day of February 2007

By: William Robert Johnson
William Robert Johnson
William Robert Johnson

State of Texas
County of Nueces

This instrument was acknowledged before me by William Robert Johnson

This the 7th day of February 2007

Xavier Galvan
Notary Public in and for the State of Texas

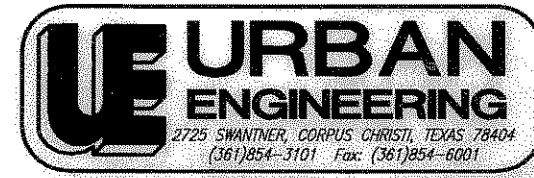
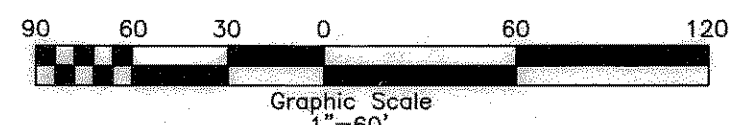
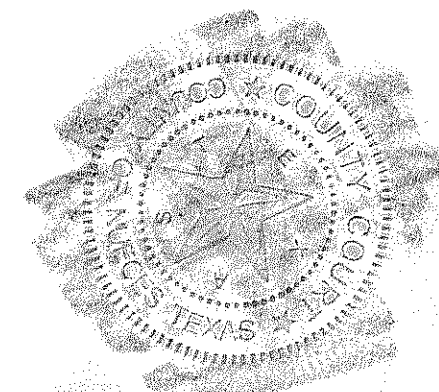
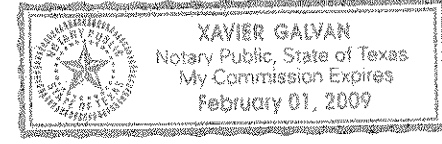

DATE: July 21, 2006
SCALE: 1"=60'
JOB NO.: 14951.A6.00
SHEET: 1 of 1
DRAWN BY: XG
© 2006 by Urban Engineering

Vol. 66 Pg. 114