

**Amending Plat of
Sand Hill Subdivision
Block 1, Lot 1**

Being a replat of Lot 1, Block 1, Sand Hill Subdivision, a map of which is recorded in Volume 62, Pages 4-5, Map Records of Nueces County, Texas.

State of Texas
County of Nueces

I, Dan L. Urban, a Registered Professional Land Surveyor for Urban Engineering, have prepared the foregoing map from a survey made on the ground under my direction and is true and correct to the best of my knowledge, information and belief; I have been engaged under contract to set all Lot and Block corners as shown hereon and to complete such operations with due and reasonable diligence consistent with sound professional practice.

This the 12th day of August, 2003

Dan L. Urban
Dan L. Urban, R.P.L.S.
Texas License No. 4710

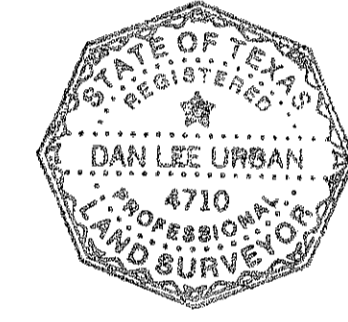

State of Texas
County of Nueces

This final plat of the herein described property was approved by the City Engineer for the City of Port Aransas, Texas.

This the 28th day of August, 2003

Glenn A. Bmdocs
City Engineer
GLENN A. BMDOCS TX # 48084

State of Texas
County of Nueces

This final plat of the herein described property was approved on behalf of the City of Port Aransas, Texas by the City Building Official.

This the 29 day of August, 2003

Joe D. Rank Jr
City Building Official

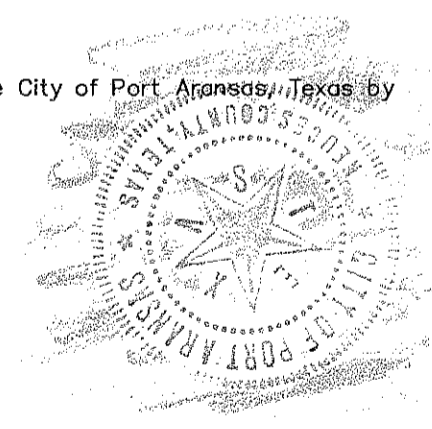

State of Texas
County of Nueces

I, Ernest Briones, Clerk of the County Court in and for said County, do hereby certify that the foregoing instrument dated the 29 day of August, 2003, with its certificate of authentication was filed for record in my office the 2 day of September, 2003, at 3:05 o'clock P.M., and duly recorded the 2 day of September, 2003, at 3:05 o'clock P.M., in said County in Volume 62, Page 200 Map Records.

Witness my hand and seal of the County Court, in and for said County, at office in Corpus Christi, Texas, the day and year last written.

No. 2003045252
Filed for Record
Ernest Briones, County Clerk
Nueces County, Texas

at 3:05 o'clock P.M.
September 2, 2003
By: *Juanita Ramirez*
Deputy

Ernest Briones
Clerk County Court
Nueces County, Texas

By: *Juanita Ramirez*
Deputy
JUANITA RAMIREZ

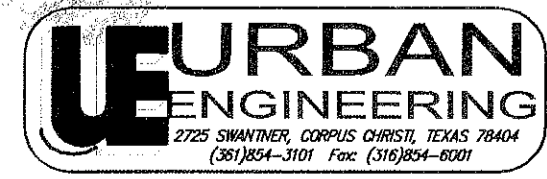

DATE: AUG. 12, 2003
SCALE: 1" = 60'
JOB NO. 36840.A2.00
SHEET 1 OF 1

State of Texas
County of Nueces

Agee & Agee Partners, hereby certifies that we are the owners of the lands embraced within the boundaries of the foregoing plat; that we have had said lands surveyed and subdivided as shown; that streets shown are dedicated to the public use forever; that easements as shown are dedicated to the public use for the installation, operation and use of public utilities; and that this map was made for the purpose of description and dedication.

This the 29 day of August, 2003

Agee & Agee Partners
Charles Agee
By: Charles Agee, President

State of Texas
County of Nueces

This instrument was acknowledged before me by Charles Agee, as President of Agee & Agee Partners, on behalf of said partners.

This the 29 day of August, 2003
Pam Hatzenbuehler
Notary Public in and for the State of Texas

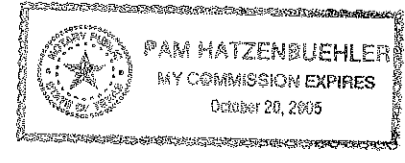

- Notes:**
- 1.) Total platted area contains 3.798 acres of land.
 - 2.) Bearings are based on the recorded plat of Lot 1, Block 1, Sand Hill Subdivision, a map of which is recorded in Volume 62, Pages 4-5, Map Records of Nueces County, Texas.
 - 3.) By graphic plotting only, this property is in Zone AE (EL 8) and Zone X on Flood Insurance Rate Map, Community Panel No. 485498 0003 F, City of Port Aransas, Texas, which bears an effective date of September 30, 1992 and is in a Special Flood Hazard Area.
 - 4.) 5 foot side yard and 10 foot rear yard required unless otherwise shown on plat.
 - 5.) The conveyance to any grantee of any Lot within the subject subdivision shall include membership in the Homeowner's Association, which association shall hold title to all common areas in the subdivision. The Homeowner's Association will be responsible for maintenance of private streets and common areas.