

LOCATION MAP N.T.S.

State of Texas
County of Nueces

I, Dan L. Urban, a Registered Professional Land Surveyor for Urban Engineering, have prepared the foregoing map from a survey made on the ground under my direction and is true and correct to the best of my knowledge, information and belief; I have been engaged under contract to set all Lot and Block corners as shown herein and to complete such operations with due and reasonable diligence consistent with sound professional practice.

This the 10th day of May, 2010
Dan L. Urban

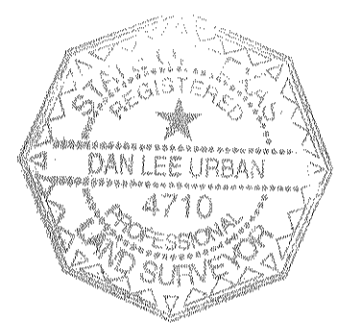

Dan L. Urban, R.P.L.S.
Texas License No. 4710

State of Texas
County of Nueces

This final plat of the herein described property was approved by the Department of Development Services of the City of Corpus Christi, Texas.

This the 12th day of May, 2010
Juan Perales, Jr.

Juan Perales, Jr., P.E.
Development Services Engineer

State of Texas
County of Nueces

This final plat of the herein described property was approved on behalf of the City of Corpus Christi, Texas by the Planning Commission.

This the 28th day of APRIL, 2010
Faryce Goode-Macon *Rudy Garza*
Faryce Goode-Macon Rudy Garza, Chairman
Secretary (10-21000066)

State of Texas
County of Nueces

I, Diana T. Barrera, Clerk of the County Court in and for said County, do hereby certify that the foregoing instrument dated the 10 day of May, 2010, with its certificate of authentication was filed for record in my office the 13 day of May, 2010, at 11:57 O'clock A.M., and duly recorded the 13 day of May, 2010, at 11:57 O'clock A.M., in said County in Volume 67, Page 380, Map Records.

Witness my hand and seal of the County Court, in and for said County, at office in Corpus Christi, Texas, the day and year last written.

No. 2010017598
Filed for Record
at 11:57 O'clock A.M.
May 13, 2010

Diana T. Barrera
Diana T. Barrera, County Clerk
Nueces County, Texas
By: *Ruby Heard*
Deputy Ruby Heard

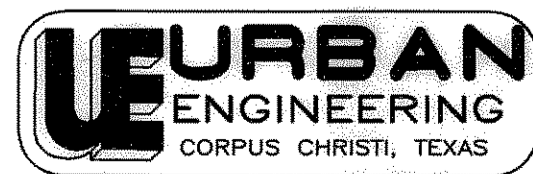
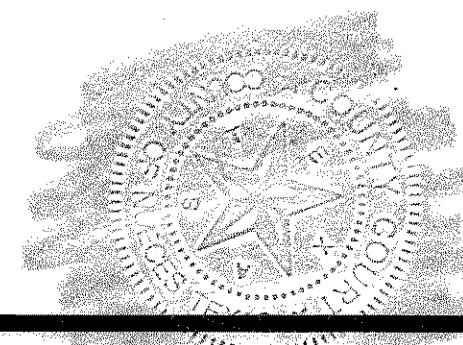

DATE: April 2, 2010
SCALE: 1" = 60'
JOB NO.: 40449.AB.00
SHEET: 1 of 1
DRAWN BY: XG

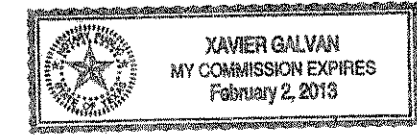

State of Texas
County of Nueces

TEXAS CHAMPION BANK, hereby certifies that it is the owner of the lands embraced within the boundaries of the foregoing plat; that it has had said lands surveyed and subdivided as shown; that streets shown are dedicated to the public use forever; that easements as shown are dedicated to the public use for the installation, operation and use of public utilities; and that this map was made for the purpose of description and dedication.

This the 10th day of May, 2010

By: *Wayne C. Meyr*
WAYNE C. MEYR, Market President - Corpus Christi

State of Texas
County of Nueces

This instrument was acknowledged before me by WAYNE C. MEYR, as Market President - Corpus Christi of TEXAS CHAMPION BANK, on behalf of said bank.

This the 10th day of May, 2010

Xavier Galvan
Notary Public in and for the State of Texas

Plat of
Lakeview Acres
Block 2, Lots 19A, 19B and 19C

being a replat of Lot 19, Block 2, Lakeview Acres, a map of which is recorded in Volume 67, Page 100, Map Records of Nueces County, Texas.

Notes:

- Total platted area contains 2.793 acres of land.
- Set 5/8 inch iron rods with red plastic cap stamped "URBAN ENGR C.C. TX" at all Lot corners, except where noted.
- The receiving water for the storm water runoff from this property is the Oso Bay. The TCEQ has classified the aquatic life use for the Oso Bay as "exceptional" and "oyster waters" and also categorized the receiving water as "contact recreation" use.
- Bearings are based on the Amending plat of Lakeview Acres, Block 2, Lots 18 and 19, a map of which is recorded in Volume 67, Page 100, Map Records of Nueces County, Texas.
- By graphic plotting only, this property is in Zone "C" on Flood Insurance Rate Map, Community Panel No. 485464 0315 D, City of Corpus Christi, Texas, which bears an effective date of August 3, 1989 and is not in a Special Flood Hazard Area.
- If any lot develops with residential uses, a park settlement fee will be assessed to that lot during the permitting phase of the development.
- If any lot is developed with residential uses, compliance with the Public Open Space regulations will be required during the building permit phase.

Vol. 67 Pg 380