

State of Texas
County of Nueces

LOCATION MAP N.T.S.

I, Dan L. Urban, a Registered Professional Land Surveyor for Urban Engineering, have prepared the foregoing map from a survey made on the ground under my direction and is true and correct to the best of my knowledge, information and belief; I have been engaged under contract to set all Lot and Block corners as shown hereon and to complete such operations with due and reasonable diligence consistent with sound professional practice.

This the 27TH day of SEPTEMBER, 2006

Dan L. Urban
Dan L. Urban, R.P.L.S.
Texas License No. 4710

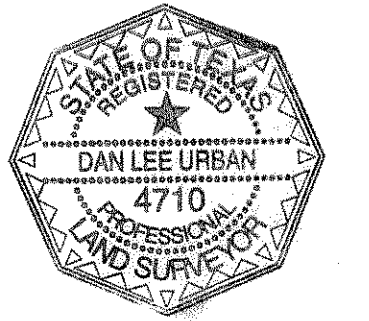

State of Texas
County of San Patricio

This final plat of the herein described property was approved by the City Building Inspector of the City of Aransas Pass, Texas.

This the 11 day of September, 2006

Frank Smith
City Building Inspector

State of Texas
County of San Patricio

This final plat of the herein described property was approved by the City Council of the City of Aransas Pass.

This the 5th day of September, 2006

Attest: *James R. Dow* Mayor
Alta Owens City Secretary

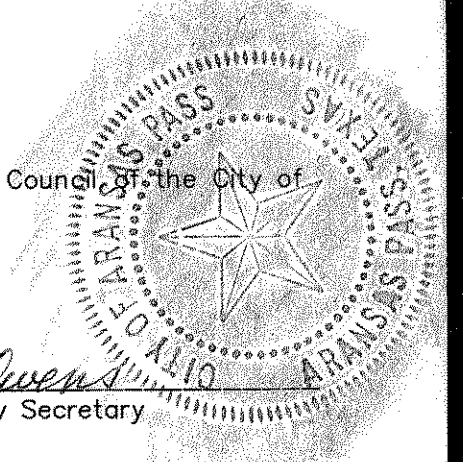

State of Texas
County of San Patricio

This final plat of the herein described property was approved on behalf of the City of Aransas Pass, Texas by the City Zoning and Planning Commission; provided however this approval shall be invalid, null and void, unless this plat is filed with the County Clerk within six (6) months hereafter.

This the ___ day of _____, 200__

James R. Dow Secretary
Kenna Simons Chairman

State of Texas
County of San Patricio

I, Gracie Alaniz-Gonzalez, Clerk of the County Court in and for said County, do hereby certify that the foregoing instrument dated the 27th day of September, 2006, with its certificate of authentication was filed for record in my office the 27th day of September, 2006. At 2:37 O'clock P. M., and duly recorded the 27th day of September, 2006, at 2:40 O'clock P. M., in said County in Envelope: 1506, Tube: 16-4, Page _____, Map Records.

Witness my hand and seal of the County Court, in and for said County, at office in Sinton, Texas, the day and year last written.

No. 561244
Filed for Record
at 2:37 O'clock P. M.
September 27, 2006

Gracie Alaniz-Gonzalez
Gracie Alaniz-Gonzalez, County Clerk
San Patricio County, Texas
By: *Janet Hanes*
Deputy

Gracie Alaniz-Gonzalez
Clerk County Court
San Patricio County, Texas
By: *Janet Hanes*
Deputy

URBAN ENGINEERING
2725 SWANNIER, CORPUS CHRISTI, TEXAS 78404
(361)854-3101 Fax: (361)854-9001

DATE: June 28, 2006
SCALE: 1"=100'
JOB NO.: 40258.00.00
SHEET: 1 of 1
DRAWN BY: XG

CURVE	DELTA ANGLE	RADIUS	TANGENT	ARC LENGTH
C1	90°00'00"	15.00'	15.00'	23.56'
C2	45°14'23"	34.50'	14.37'	27.24'
C3	270°28'46"	50.00'	49.58'	236.04'
C4	180°28'46"	50.00'	11950.00'	157.50'

LINE	BEARING	DISTANCE
L1	N55°23'00"W	72.00'

1 PG 561244
PLAT

FILED AND RECORDED
OFFICIAL PUBLIC RECORDS

Gracie Alaniz-Gonzalez
Gracie Alaniz-Gonzalez, County Clerk
San Patricio Texas



September 27, 2006 02:37:18 PM
FEE: \$81.00 561244

Plat of
Flamingo Landing

9.218 acres of land being all of Lots 6 and 7, Outlot 38, of the Burton and Danforth Subdivision, a map of which is recorded in Volume 1, Pages 62-63, Map Records of San Patricio County, Texas; save and except a tract 72.00 feet by 320.00 feet out of the southwest corner of said Lot 6.

- Notes:
- 1.) Total platted area contains 9.218 acres of land. (Includes Street Dedication)
 - 2.) Set 5/8 inch iron rods with red plastic cap stamped "URBAN ENGR C.C. TX" at all lot corners, except where noted.
 - 3.) Bearings are based on the recorded plat of The Highlands, a map of which is recorded in Volume 13, Page 2, Map Records of San Patricio County, Texas.
 - 4.) By graphic plotting only, this property is in Zones "B" and "C" on Flood Insurance Rate Map, Community Panel No. 485453 0018 B, City of Corpus Christi, Texas, which bears an effective date of March 4, 1985 and is not in a Special Flood Hazard Area.

State of Texas
County of Nueces

J.J. FOX CONSTRUCTION, INC., hereby certifies that it is the owner of the lands embraced within the boundaries of the foregoing plat; that it has had said lands surveyed and subdivided as shown; that streets shown are dedicated to the public use forever; that easements as shown are dedicated to the public use for the installation, operation and use of public utilities; and that this map was made for the purpose of description and dedication.

This the 26th day of September, 2006

By: J.J. FOX CONSTRUCTION, INC.

Tommy Fox
TOMMY FOX, President

State of Texas
County of Nueces

This instrument was acknowledged before me by TOMMY FOX, as President of J.J. FOX CONSTRUCTION, INC., on behalf of said corporation.

This the 26th day of September, 2006

Gracie Alaniz-Gonzalez
Notary Public in and for the State of Texas

